

# DRV SERIES GROUND DRIVES

## PARTS AND INSTRUCTIONAL MANUAL



DRV-3000 Shown

### **CDS-JOHN BLUE COMPANY**

DIVISION OF ADVANCED SYSTEMS TECHNOLOGY, INC.  
290 Pinehurst Drive - Huntsville, Alabama 35806  
P.O. Box 1607 - Huntsville, Alabama 35807

Telephone: (256) 721-9090 - FAX: (256) 721-9091 - Toll Free: 1-800-253-2583

# SAFETY PRECAUTIONS

- Equipment should be operated only by responsible people.
- A careful operator is the best insurance against an accident.

**WARNING:** USE OF THIS PRODUCT FOR ANY PURPOSES OTHER THAN ITS ORIGINAL INTENT, ABUSE OF THE PRODUCT, AND/OR MODIFICATION TO THE ORIGINAL PRODUCT IS STRICTLY PROHIBITED BY CDS-JOHN BLUE COMPANY. CDS-JOHN BLUE COMPANY RESERVES THE RIGHT TO DENY WARRANTY OR LIABILITY CLAIMS IN ANY/ALL SITUATIONS INVOLVING MISUSE, ABUSE OR MODIFICATION.

THE ORIGINAL INTENT OF THIS PRODUCT DOES NOT INCLUDE USE WHERE THE MAXIMUM ALLOWED SPEED, PRESSURE, OR TEMPERATURE IS EXCEEDED, AND IT DOES NOT INCLUDE APPLICATIONS UTILIZING FLUIDS THAT ARE NOT COMPATIBLE WITH THE PRODUCT'S COMPONENT MATERIALS. DO NOT USE THIS PRODUCT WITH FLAMMABLE OR COMBUSTIBLE FLUIDS SUCH AS GASOLINE, KEROSENE, DIESEL, ETC..., AND DO NOT USE IN EXPLOSIVE ATMOSPHERES. FAILURE TO FOLLOW THIS NOTICE MAY RESULT IN SERIOUS INJURY AND/OR PROPERTY DAMAGE AND WILL VOID THE PRODUCT WARRANTY. IF IN DOUBT ABOUT YOUR APPLICATION, CONTACT YOUR STOCKING DEALER OR THE CDS-JOHN BLUE TECHNICAL STAFF AT 1-800-253-2583.

# TABLE OF CONTENTS

Safety Precautions .....	2
Table of Contents .....	2
Component List .....	3
Diagram – DRV 3000, 3100, 3300 Gage Wheel .....	4
Diagram – DRV 3200 Planter Mount .....	5
Warranty .....	6

## DRV Universal Drive Component List

Item	Part #	Description	DRV-3000 Fixed Height Drive	DRV-3100 Gage Wheel Only	DRV-3200 Planter Mount	DRV-3300 Spring Load Drive
1	92031	½-13 JAM NUT	2		1	2
2	92029	½-13 HEX NUT	2		1	2
3	93012	7/16 FLAT WASHER	6		3	6
4	A-401	IDLER SPOOL	2		1	2
5	A-512	FERRULE	2		1	2
6	115944-01	IDLER BRACKET	2		1	2
7	90699	½-13 X 3-1/4 BOLT	2		1	2
8	93018	¾ SAE FLAT WASHER	4	4	4	4
9	93028	¾ LOCK WASHER	4	4	4	4
10	92039	¾-10 HEX NUT	4	4	4	4
11	93011	3/8 FLAT WASHER	15	2	10	15
12	93024	3/8 LOCKWASHER	15	2	8	15
13	92024	3/8-16 HEX NUT	10	2	8	10
14	90860	3/8-16 X 1 BOLT	4	2	4	4
15	115938-91	PUMP MOUNT – PISTON	1		1	1
16	90653	3/8-16 X 1-1/4 BOLT	4		4	4
17	115916-01A	COLLAR	2		2	2
18	115915-01	RETAINING RING	2		2	2
19	L-1017	BEARING	2		2	2
20	115933-91	PIVOT PLATE TUBE	1	1	1	1
21	112661-01 114932-01 114936-91	SPROCKET – RC50-18T SPROCKET – RC40-32T SPLT. SPKT.- RC40-32T	1		1	1
22	L-1020	¼" STD. KEY	2		2	2
23	112794-01	SPROCKET – RC50-24T	1		1	1
24	115934-01	JACK SHAFT	1		1	1
25	90663	3/8-16 X 3-1/2 BOLT	2			2
26	115923-91	ARM – WELDMENT ASSEMBLY	1	1		1
27	93013	½ FLAT WASHER	4	4		4
28	92048	½-13 LOCK NUT	2	2		2
29	90700	½-13 X 3-1/2 BOLT	2	2		2
30	A-1363	WHEEL – 15" - 5 BOLT	1	1		1
31	115925-01	SPINDLE	1	1		1
32	M-330	GREASE SEAL	2	2		2
33	42500	CONE BEARING	1	1		1
34	42000	CUP BEARING	1	1		1
35	115900-02	HUB	1	1		1
36	M-327	OUTER CUP BEARING	1	1		1
37	M-326	OUTER CONE BEARING	1	1		1
38	115926-01	SPACER - SEAL	1	1		1
39	94017	COTTER PIN	1	1		1
40	115927-01	1-1/2 – 12 HEX NUT - SLOTTED	1	1		1
41	A-8148	FERRULE	5			5
42	A-1342-BP	SPROCKET – RC50 – 50T	1			1
43	91059	3/8-16 X 2-1/4 BOLT	5			5
44	S-5476	¼ X 1-1/4 ROLL PIN	1	1		1
45	115924-01	GAUGE PIN	1	1		
46	A-6350	COTTER PIN	1	1		1
47	115943-A 114934-01	RC50 CHAIN – 93 LINKS RC40 CHAIN – 61 LINKS	1		1	1
48	115943-B	RC50 CHAIN – 107 LINKS	1		1	1
49	115946-91	GAUGE ADJUSTMENT	1	1		
50	115911-91	SHOCK ASSEMBLY	1			1
51	115904-91	UNIVERSAL MOUNT	1	1	1	1
52	M-394	9/16-18 X 1-1/8 – LUG BOLT	5	5		5
53	115931-91	SPINDLE ASSEMBLY	1	1		1
54	115907-01A 115907-01B 115907-01C 115907-01D 115907-01E	U-BOLT 7 X 7 BAR (2 req'd) U-BOLT 4 X 4 BAR (2 req'd) U-BOLT 4 X 6 BAR (2 req'd) U-BOLT 6 X 6 BAR (2 req'd) U-BOLT 9 X 9 BAR (2 req'd)	NOT INCLUDED	NOT INCLUDED	NOT INCLUDED	NOT INCLUDED

# DRV 3000, 3100, 3300 – Ground Drive/Gage Wheel

\*\* Note: Idler bracket positions and rotation directions are shown for Push Type installation

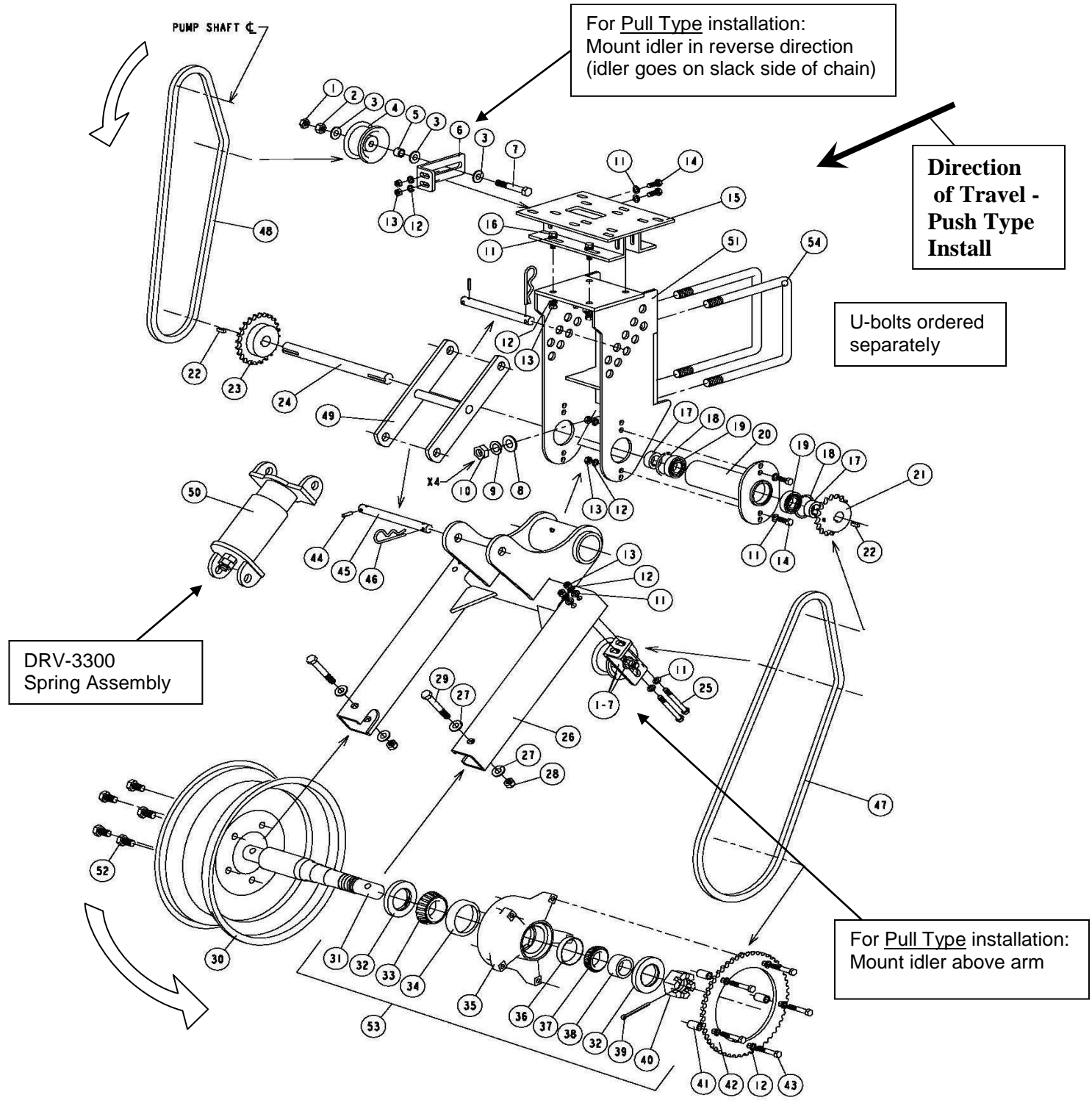

# DRV-3200 – Planter Drive

See pages 3 and 4 for part numbers of shared components

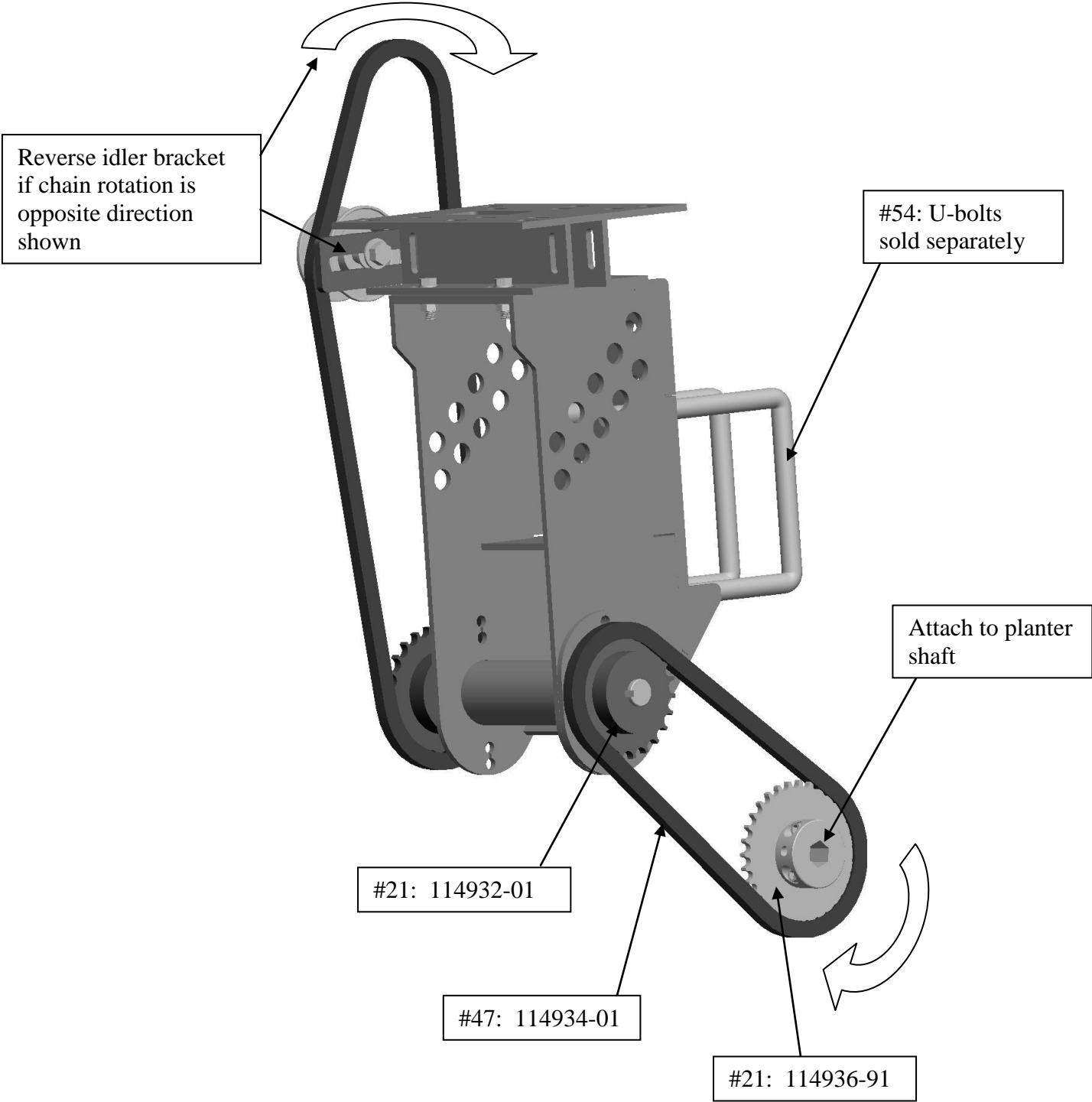

## LIMITED WARRANTY

THIS WARRANTY IS IN LIEU OF ALL OTHER WRITTEN OR EXPRESS WARRANTIES AND REPRESENTATIONS. ANY IMPLIED WARRANTIES INCLUDING MERCHANTABILITY OR FITNESS FOR ANY PARTICULAR PURPOSE ARE EXPRESSLY LIMITED TO THIS WRITTEN WARRANTY. CDS-JOHN BLUE COMPANY SHALL NOT BE LIABLE FOR CONSEQUENTIAL DAMAGES.

Use of this product for any purpose other than its original intent, abuse of the product, and/or any modification to the original product is strictly prohibited by the manufacturer, CDS-John Blue Company. Any modification to the product should be approved by CDS-John Blue Company prior to use. CDS-John Blue Company will deny Warranty claims and liability in any situation involving misuse, abuse or modification.

Each new machine or component manufactured by CDS-John Blue Company through original buyer is warranted by CDS-John Blue Company to buyer and to any party or parties to whom buyer may resell, lease or lend the equipment to be free from defects in material and workmanship under normal use and service. This obligation of CDS-John Blue Company under this warranty is limited to the repair or replacement of defective parts or correction of improper workmanship of any parts of such equipment which shall within one year from the date of CDS-John Blue's original delivery thereof, be returned to CDS-John Blue's factory, transportation charges prepaid and which CDS-John Blue Company shall determine to its satisfaction upon examination thereof to have been thus defective. When it is impractical to return the defective parts of such equipment to CDS-John Blue's factory, then CDS-John Blue shall have no liability for the labor cost involved in repairing or replacing any such parts and shall be liable solely for supplying the material necessary to replace or repair the defective parts, provided that prior thereto CDS-John Blue Company shall have determined to its satisfaction that any such parts are thus defective.

This warranty shall not apply to any equipment which shall have been repaired or altered outside CDS-John Blue's factory in any way so as to affect its durability, nor which has been subjected to misuse, abuse, negligence or accident, or operated in any manner other than in accordance with operating instructions provided by CDS-John Blue Company. This warranty does not extend to repairs made necessary by the use of inferior or unsuitable parts or accessories, or parts or accessories not recommended by CDS-John Blue Company.

CDS-John Blue Company makes no warranties in respect to parts, accessories or components not manufactured by CDS-John Blue Company, same ordinarily being warranted separately by their respective manufacturers.

DIVISION OF ADVANCED SYSTEMS TECHNOLOGIES                      HUNTSVILLE AL                      (256) 721-9090



### **CDS-John Blue Company**

**Division of Advanced Systems Technology**

290 Pinehurst Dr. Huntsville AL 35806

PO Box 1607 Huntsville AL 35807

Telephone: (256) 721-9090 - Fax (256)-721-9091 - Toll Free 1-800-253-2583

[www.cds-johnblue.com](http://www.cds-johnblue.com)

**YOUR LOCAL DEALER**

