



# CV Series Check Valve Parts Breakdown

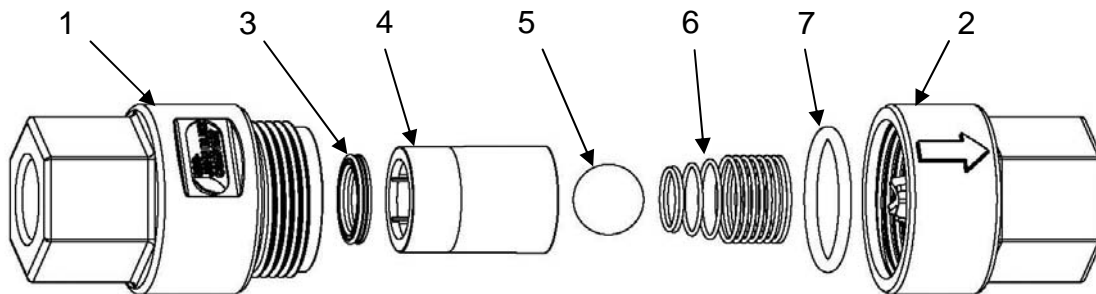
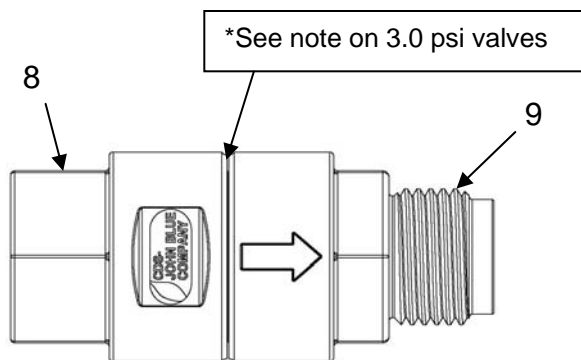

Figure 1: CV-1101 (1psi) or CV-1103 (3psi) with 1/4" NPTF Ports



Cracking Pressure =	1.0 or 3.0 psi
Max. Working Pressure =	150 psi
Max. Flow =	2.25 gpm
Materials:	Body = Polypropylene
	Ball & Spring = 316 SS
	Seals = Viton

Figure 2: CV-1201 (1psi) or CV-1203 (3 psi) with 11/16" Straight Thread Ports

Item	Description	Part #
1	1/4" NPTF Inlet Section, PP	115974-01
2	1/4" NPTF Outlet Section, PP	115975-01
3	Viton Ball Seal	115984-01
4	Insert Sleeve, PP	116018-01
5	Ball, 316 SS	115983-01
6	1.0 psi Spring, 316 SS	115978-01
6a	3.0 psi Spring, 316 SS (* Note: Optional 3.0 psi spring valves are identified by stamping a "3" into the valve body side.)	115986-01
7	Viton Body O-ring	115979-01
8	11/16"-16 Female Inlet Section, PP	115976-01
9	11/16"-16 Male Outlet Section, PP	115977-01
Optional 1/4" NPT Fittings:		
Polypropylene Barb Fittings: 115981-01 = 1/4", 113571-01 = 3/8", 115982-01 = 1/2" (sized for tube I.D.)		
Polypropylene Push-in Fittings: 115960-01 = 1/4", 113561-01 = 3/8" (sized for tube O.D.)		



# CV Series Injection Check Parts Breakdown

CV-1310 with 1/4" NPTF Inlet and 1/2" NPTM Outlet Port

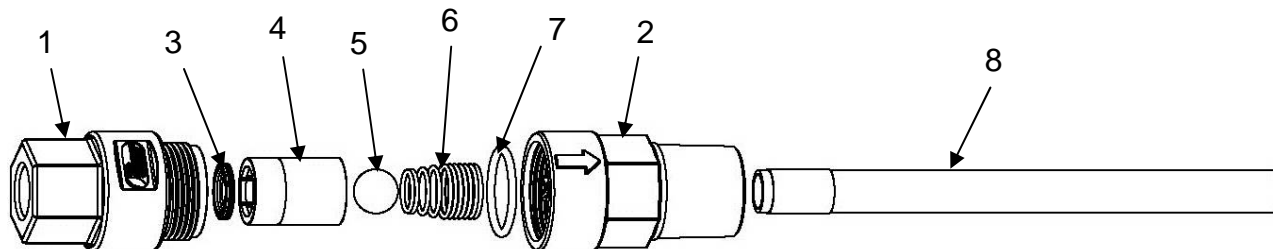

CV-1310-BL with 1/2" NPTM Inlet & 1/4" NPTF Bleed Port

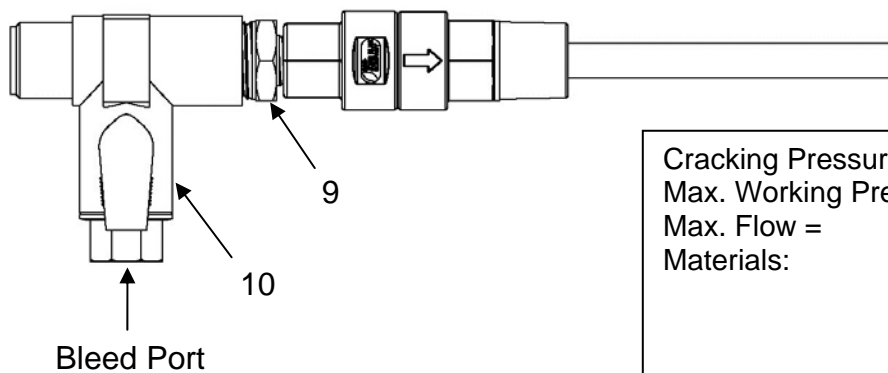

Cracking Pressure =	10 psi
Max. Working Pressure =	150 psi
Max. Flow =	100 gph
Materials:	CV Body = Polypropylene
	Bleed Valve Body = PVC
	Ball, Spring, & Tube = 316 SS
	Seals = Viton

Item	Description	Part #
1	1/4" NPTF Inlet Section, PP	115974-01
2	1/2" NPTM Outlet Section, PP	115987-01
3	Viton Ball Seal	115984-01
4	Insert Sleeve, PP	116018-01
5	Ball, 316 SS	115983-01
6	10 psi Spring, 316 SS	115989-01
7	Viton Body O-ring	115979-01
8	Outlet Tube, 316 SS	115988-01
9	Reducing fitting – 1/2" NPT to 1/4" NPT, PP	116225-01
10	Bleed valve – PVC body with viton seals	116224-01