

CDS-John Blue Corner

The Early Order Packets

have been mailed: Additional copies of the 2015-16 product catalog and numeric pricing are available on our web site or by contacting the sales department at 800-253-2583. New this year, we are offering early order pricing on the centrifugal pumps, see the centrifugal net price sheet for all the details. Don't be left out in the cold, taking advantage of early order means you will have product when you and your customers need it!

We are pleased to introduce Two New Employees-Ryne Gay and Corey Pedigo.

Ryne, Sales Engineer, received his BS degree in Agricultural Technology and Business from Mississippi State. Corey is a Design Engineer and graduated with his Bachelor of Science degree from Tennessee Technology University. Please help us in welcoming Ryne and Corey to the CDS-John Blue Team.

(See back panel for more CDS-John Blue Corner News)

NEW!! NH3 VisaGage II with Electronic Blockage Monitor System

Many of your customers already know the features and benefits of the **VisaGage II Flow Monitor and Liquid Blockage Monitor System (LBMS)**. For one WI grower that payoff came in the form of helping him catch a minor issue before it became a problem. Due to spring rains, the corn grower wasn't able to go to the field and apply his zinc pop-up. The zinc sat for a few days and started to crystallize, he didn't realize it. The newly installed CDS-John Blue LBMS quickly indicated that 2 rows were suffering from a blockage and he immediately fixed the problem. A potential big problem-de-railed. Read more about it on our web site at: <http://www.cds-johnblue.com/article-052615.shtml>.

What works for liquid will now work for NH₃. We are pleased to introduce the

new **NH₃ VisaGage** that is also coupled to the **Electronic Blockage Monitor System**. You can monitor your NH₃ or N-Serve flow rates from your tractor cab. The NH₃ VisaGage is mounted to the LBMS sensor, which identifies where the magnetic balls are floating in each row during application. The sensors show both low and no flow, plus the premium wireless systems show high flow. Correct problems immediately or pause to capture the row for investigation later. Our patented system is available with three display options: wired control panel, Apple iPad and Android wireless systems.

The NH₃ VisaGage is manufactured from polymethylpentene (TPX®) chemical resistant bodies with UV protection, polypropylene balls, ball screen and Buna-N o-rings and aluminum manifolds. Maxi-

imum allowed pressure in the monitor is 100 psi. The NH₃ VisaGage is available in 2 and 4 row units:

**2 Row Part Number:
SMFD2-NH3**

**4 Row Part Number:
SMFD4-NH3**



CDS-John Blue Corner

(Continued from front)

Inventory Announcement:

We will be conducting a physical inventory September 21-25. We will only ship parts for next day air orders during this week. We thank you for your patience.

Web Updates: Our recently introduced new products: Direct Hydraulic Drive Piston Pump, NH3 VisaGage, VisaGage Orifice Selector are now available on our web site along with the instruction manuals and schematics for easy reference.

NEW LBMS Flow Monitors and VisaGage II Calculators are available on the web site or on your mobile device. Simply answer a few questions to easily determine the most suitable ball to use in your VisaGage II or LBMS.

Price Updates: please note the updated list prices:

- A-3255-A \$24.78
- A-452 \$1.07
- AK1321W \$22.31
- AKSC15-200 \$166.07
- AKSCP-017 \$53.36
- DP-84368550 \$1.78
- DP-94030232 \$81.73
- DRV-3300 \$1834.02
- S-3633 \$22.21
- 105899-02 \$137.36
- 54-2120 \$838.50

Check Out Our New Products

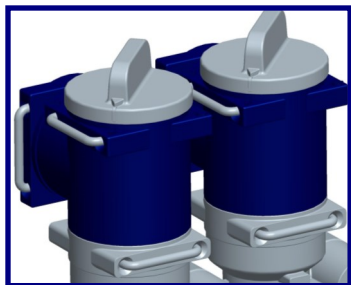

We have taken our popular VisaGage II Flow Monitor and turned it into a **Self-Contained**

Orifice Selector. Growers with existing VisaGage units can simply remove the outlet adapter from each column and install the orifice selector in each row. Two orifice discs are provided, each disc provides four orifice settings. It's easy to adjust between the four different orifice sizes, simply turn the dial to the appropriate setting. Quick adjustment, no more working with plumbing near the ground or getting wet from fertilizers or chemicals. For easy reference, the Orifice Selector Chart is available on our web site.

VisaGage Orifice Selector Part Numbers

SMPT-OSA1: Single Orifice Selector Kit
SMPT-OSA4: Set of 4 Orifice Selector Kit

CDS-John Blue is also excited to introduce the first of it's kind, **Direct Hydraulic Drive Piston Pump.** As more growers

are using sectional shut-off and variable rate technology, the new Direct Hydraulic Drive Piston Pump is their answer.

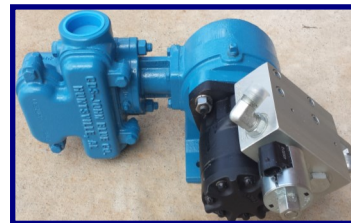

This pump is a lower cost, more compact solution for variable rate piston pump drives. Users can supply their own SAE A 2-bolt motor or a hydraulic motor/PWM manifold kit is available from CDS-John Blue Company. All CDS-John Blue Piston Pumps are built to last, engineered for performance. Only self-priming piston pumps can lift product from your tanks, plus application rates do not change due to temperature fluctuations.

Direct Hydraulic Drive Piston Pumps

NGP-4055-HYF	NGP-6055-HY
NGP-6055-HYF	NGP-7055-HY
NGP-7055-HYF	



*Your success is our success. That is why at this time of year, we would like to take a moment to say **thank you** for your patronage during the 2014-15 sales year. As we prepare for the 2015-16 season, we wish you continued success and please know your CDS-John Blue Team is here for your support. We are very excited about the new sales year; especially the introduction of many newly released innovative products.*