

Centrifugal Products



Flanges

- FEATURES:**
- Eliminate leaks with flanged fittings.
 - Easier to plumb your system, can replace existing threaded fittings in your plumbing system.
 - Cast iron flanges available for all 2" and 3" centrifugal pumps.
 - Replacement inlet and outlet flanges.
 - 2-year unconditional warranty.

Part Number for Centrifugal Pumps with Flanges:
Add -FLG after model part number.

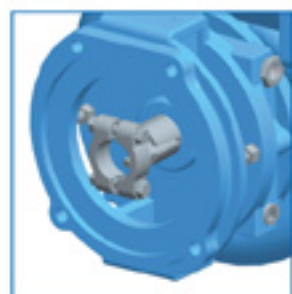

Keyed Shaft Clamp

- FEATURES:**
- Available on 3" gas engine model pumps.
 - Prevents shaft slippage during operation.

LCT Engines



- FEATURES:**
- Now available LCT Engines for all gasoline engine centrifugal pumps.
 - Available in 5 HP recoil start and 13 HP electric start.
 - Engines can be serviced at any Tecumseh dealers.
 - 2-year warranty.

Part Number:
5 HP engine add -G5LCT after pump model number.
13 HP engine add-G13LCT after pump model number.

CDS-John Blue Technical Sales Department is available to answer all of your questions.



CDS-John Blue Company, Division of Advanced Systems Technology, Inc.
PO Box 1607 Huntsville, AL 35807
Tel: 800-253-2583, 256-721-9090, FAX: 256-721-9091
E-mail: info@cds-johnblue.com
www.cds-johnblue.com

Find us on Facebook CDS-John Blue Company

Printed on recycled paper.
© CDS-John Blue Company

QUALITY MANAGEMENT
SYSTEM CERTIFIED BY DNV
ISO 9001



Celebrating 125 Years with our Recently Released Product Line-Up

Irrigation Products:



Poly Injection Check Valve

- FEATURES:**
- 200 gph maximum capacity continuous flow (Duplex).
 - 100 gph maximum capacity (Simplex).
 - More uniform distribution of products.
 - Prevents backflow, siphoning and bleed through of product.
 - Easy to install and maintain.
 - Glass-reinforced polypropylene body, all Viton seals and 316 stainless steel spring, ball and injection tube.
 - 10 psi spring.

Poly Injection Check Valves

Part Number	Description
CV-1310	Poly Injection Check Valve Assembly, 1/4" NPT Female Inlet x 1/2" Male Outlet

Variable Rate Hydraulic Drive Kit for John Deere GreenStar™

- FEATURES:**
- Base kit to add variable rate capacity to a CDS-John Blue Piston Pump for the John Deere GreenStar System.
 - Existing pumps can be easily converted to variable rate.
 - Two types of flow control valves (servo or PWM).
 - A piston pump allows for quick and stable adjustment to application rates.
 - With a piston pump your application rates won't change with the temperature.
 - Hydraulic 2-way bypass valve turns pump and liquid flow on and off.

Variable Rate Hydraulic Drive Kit

Part Number*	Description
VRH-JD-10	Variable Rate Hydraulic Kit for John Deere GS2 and GS3. Includes: mounting bracket, chain, sprockets, hydraulic motor, servo flow control manifold, custom adaptor harness and setup instructions with parts list for obtaining off-the-shelf components to complete installation.
VRH-MAN-10	Non-variable rate speed control system. Includes: manual flow control valve and optical tachometer (to set pump speed), mounting bracket, chain, sprockets, hydraulic motor with NPT ports.

***Coming soon! Additional variable rate hydraulic drive kits for other systems!**



Photo is 116043-91 Drive Mount Assembly with NGP-6055 and 115907-01A U-bolts.

Planter and Applicator Products:

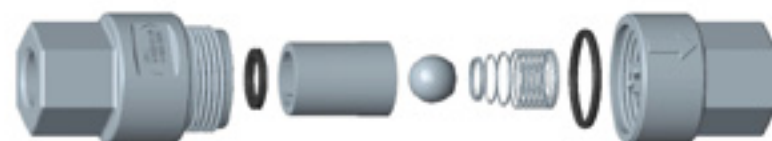

Delivery Line Check Valves:

FEATURES:

- Easy to Clean.
- Repairable.
- New and Improved Check Valve.
- Easier to service in the field.
- 1 psi.
- Precision molded in Glass-reinforced polypropylene.
- 316 stainless steel spring and ball.
- All Viton seals.

Poly Applicator Check Valves

Part Number*	Description
CV-1101	Poly Check Valve, 1/4" NPT Female Inlet and Outlet
CV-1101-B14	Poly Check Valve, 1/4" Hose Barbs Inlet and Outlet, replaces 115284-01
CV-1101-B38	Poly Check Valve, 3/8" Hose Barbs Inlet and Outlet, replaces 115285-01
CV-1101-B12	Poly Check Valve, 1/2" Hose Barbs Inlet and Outlet, replaces 115286-01

*3 psi spring and 11/16" straight inlet/outlet threads are available, contact the sales department.



Flow Dividers:

FEATURES:

- Introducing the FD-0610, 6 outlet Flow Divider (photo left).
- Newly revised Flow Dividers: FD-1210 and FD-2010.
- Improved accuracy at lower application rates.
- Spherical designed needle tip has better impact resistance.
- Added wrench flats for ease of installation.
- Numbered ports for ease of tracing lines on the FD-1210 and FD-2010 models.

Flow Dividers

Part #*	Description	Inlet	Outlet	Maximum Flow/Outlet
FD-0610	6 Outlet SS	3/4" FPT	1/4" FPT	2.25 GPM
FD-1210	12 Outlet SS	3/4" FPT	1/4" FPT	2.25 GPM
FD-2010	20 Outlet SS	1" FPT	1/4" FPT	2.25 GPM

*Other types of fittings are available. Contact the sales department.

Flow Divider Adjustable Spring Kit

FEATURES:

- Adjustable spring kit will enable you to balance multiple flow dividers.
- Kit may be purchased separately or pre-installed on any size flow divider.
- Call sales department for adapting to existing flow dividers.
- When using multiple flow dividers the same size flow dividers must be used, the number of plugged outlets should be identical and the plugs equally spaced. The maximum recommended differential between flow dividers is two plugged ports.

Flow Divider Adjustable Spring Kit

Part Number*	Description
FD-0610-ADJ	6 Outlet Stainless Steel Flow Divider with Adjustable Spring Kit
FD-1210-ADJ	12 Outlet Stainless Steel Flow Divider with Adjustable Spring Kit
FD-2010-ADJ	20 Outlet Stainless Steel Flow Divider with Adjustable Spring Kit
116063*	FD-0610 Retrofit Kit
116064*	FD-1210 Retrofit Kit
116065*	FD-2010 Retrofit Kit

*Kit will include the adjustment bolt, nut, spring seat, cap with straight threads (for 12 or 20 port kits) and vented plug.

Dual Adjustable Rate NGP-8055-AR

FEATURES:

- Apply two products with one piston pump.
- Use only one drive system.
- Independently adjustable stroke.
- 5 to 1 max ratio between pumping heads.
- Available as a ground driven pump or run hydraulically with Variable Rate.
- Ideal for starter fertilizer on one side and nitrogen on the other side. For example:
 - 5 GPA starter fertilizer and 5-25 GPA NPK
 - 7 GPA starter fertilizer and 7-35 GPA NPK
- Double piston-double acting.
- Variable Stroke.
- Rated Flow – 42 GPM total, 21 GPM per side.
- Rated Pressure – 120 PSI
- Rated Speed – 450 RPM maximum
- Inlet – 1 1/2" FPT
- Outlet – 1 1/2" FPT

Part Number: **NGP-8055-AR** (shown)

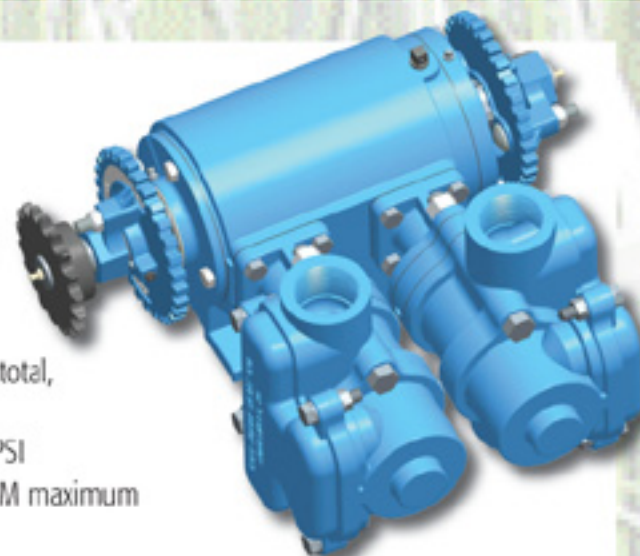

Flow Monitor Products VisaGage II for Fumigants

FEATURES:

- Compatible with fumigants, especially Telone.
- Polysulfone chemical resistant bodies with UV protection.
- Available for spraying or fertilizer applications in single columns or sets of four flow monitor assemblies.
- All standard with Viton seals.
- Can be easily distinguished from standard VisaGage II's by the color of the body.
- Same features as the standard CDS-John Blue VisaGage II.



VisaGage II for Fumigants

Part Number	Description
SMSS1-FUM	Single Flow Monitor Assembly – Spray type includes single body, 3/8" NPT female inlet and outlet, (5) 1/2" diameter balls, end cap, Viton O-rings and stainless steel retainer clips.
SMSS4-FUM	Set of 4 Flow Monitor Assembly – Spray type includes 4 bodies, 1/2" NPT female inlet, 3/8" NPT female outlet, (20) 1/2" diameter balls, end cap, Viton O-rings and stainless steel retainer clips.
SMFD1-FUM	Single Flow Monitor Assembly – Flow Divider Type includes single flow divider monitor body, 3/8" NPT female inlet and outlet, (5) 1/2" diameter balls, Viton O-rings and stainless steel retainer clips.
SMFD4-FUM	Set of 4 Flow Monitor Assembly – Flow Divider Type includes 4 bodies, 3/8" NPT female inlet and outlet, (20) 1/2" diameter balls, Viton O-rings and stainless steel retainer clips.